



Wildflower Meadow

Maybank-Rhett Nature Center

Richard Eppler Overlook

Future Multiuse Path Concept

N. Highland Lake Rd.

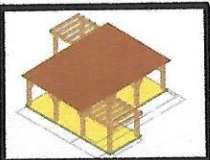

Playground Shelter

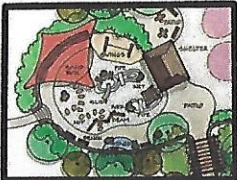

Tot Lot Concept

Future Multiuse Path Concept



Robert V. Staton Pavilion

Ed Lastein Trail

Highland Lake Dr.

Future Parking Lot Concept

Future Reforestation

Highland Park Rd.

Future Entrance Concept

N. Highland Lake Rd.

Future Multiuse Path Concept

Trail Surface:

Grey = Asphalt

Gold = Granite Fines



Bryan Playground



Welcome Center

Courtyard Concept:
 - Donor Wall
 - Kiosk
 - Seating

This Master Site Plan represents a vision for The Park at Flat Rock. It is based on our community values and a desire to provide a place of natural beauty for people to enjoy. Protecting and enhancing this space will improve the quality of life for all who use it. This plan's purpose is to inspire and guide the orderly development of the park. Open space, walking trails, picnic areas and playgrounds are the main features. Structures will provide basic services and shelter. Natural habitat will be protected to support environmental education. The Park at Flat Rock is designed to be uniquely Flat Rock, yet is universal in appeal. It will allow people of all ages to interact with nature while improving health and wellness of the greater community.

Master Site Plan
THE PARK
at Flat Rock

Village of Flat Rock Master Site Plan
 Adopted: March 8, 2018

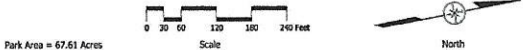

Park Area = 67.61 Acres